



DATASHEET

GAUGE HATCH FOR BULK STORAGE TANKS

CNC 101 / 102 Gauge Hatches



101

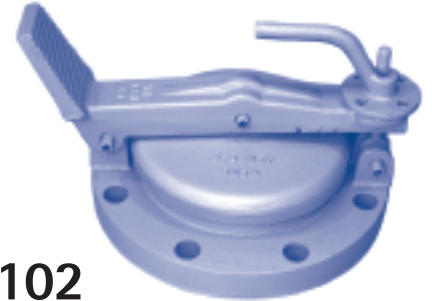

102

APPLICATION

Motherwell Tank Protection (MTP) range of gauge hatches allow easy access to atmospheric liquid storage tanks for manual level measurement (dipping), temperature measurement and sampling.

BENEFITS

- Robust construction to cope with regular use.
- Range of **sizes and materials** to suit a wide range of applications
- **Non-sparking feature, provided by the use of a PTFE or Nitrile rubber insert**
- The cover is designed with a condensation rim. This encourages liquid drainage from the surface to reduce the possibility of freezing.
- Lockable handle and gas tight seal to 2.5 psig (CNC 102).
- ATEX approved to directive 94/9/EC

PRINCIPLE OF OPERATION

Provides tank access where manual level gauging, temperature measurement or sampling is required. The safety pedal allows the operator to open the gauge hatch whilst remaining 'hands free' to carry out required measuring.

PHYSICAL

Model	101, 102
Sizes	4", 6", 8", 10" 12"
Process Connection	1. ANSI 150# (Standard) 2. PN10 / PN16 3. Special (Flange drilling as required)
Materials	1. Aluminium 2. Cast Iron 3. Carbon Steel 4. Stainless Steel
Insert	1. Nitrile 2. PTFE

PROCESS

Pressure Setting ≤ 2.5 psig (CNC102 only)

ORDERING CODE

MODEL-SIZE-PROCESS CONNECTION-MATERIAL-INSERT

e.g. 101-04-111 (101 series, 4" ANSI 150# connection, Aluminium body, Nitrile insert)

AFTER SALES SUPPORT

MTP provide comprehensive spares support, and term preventative maintenance schemes using product-trained technicians to service MTP and other brands of valves and fittings.

Motherwell Tank Protection

St Michaels Road

Lea Green Ind Est

St Helens

Merseyside

England WA9 4WZ

Tel : + 44 1744 815211

Fax : +44 1744 814497

sales@motherwelltankprotection.co.uk

www.motherwelltankprotection.co.uk



FM22144



INVESTOR IN PEOPLE

